

# NEXT

QUICK INSTALLATION GUIDE

## Wall Mount

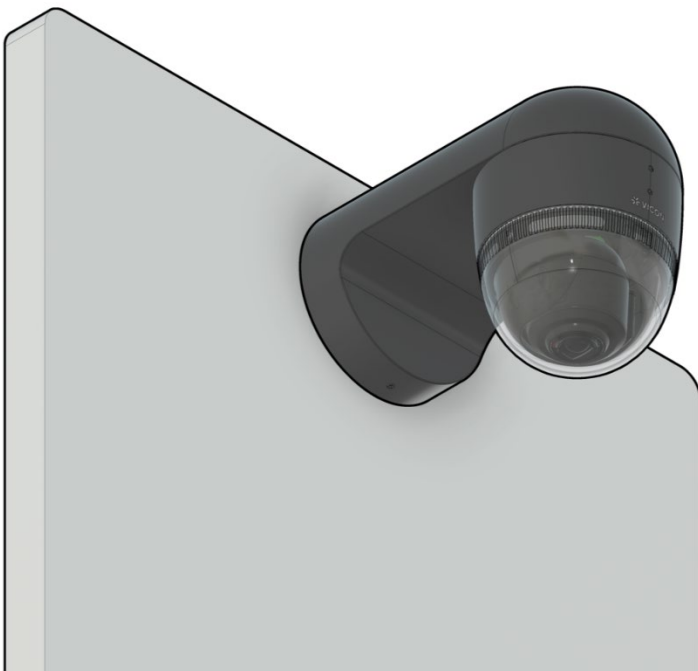

# WARNING

- This camera operates at PoE (IEEE 802.3at minimum).
- Installation and service should be performed only by qualified and experienced technicians and comply with all local codes and rules to maintain your warranty.
- We are NOT liable of any damage arising either directly or indirectly from inappropriate installation which is not depicted within this documentation.
- To reduce the risk of fire or electric shock during installation, do not expose the product to rain or moisture.
- To remove fingerprints, dust, contaminants, etc., that could occur during installation, wipe the camera with a dry soft cloth. For tough stains, slightly apply a diluted neutral detergent and wipe with a dry soft cloth.
- Do not apply benzene or thinner to the camera, which may cause the surface to melt or lens to fog.
- Avoid aligning the lens with extremely bright objects (e.g., light fixtures) for long periods of time.
- Although this camera is waterproof and suitable for both indoor and outdoor usages, please do not immerse the camera into water.
- Avoid operating or storing the camera in the following locations:
  - Extremely humid, dusty, or hot/cold environments (recommended operating temperature: -40 to 131° F/-40°C to +55°C)
  - Close to sources of powerful radio or TV transmitters
  - Close to fluorescent lamps or objects with reflections
  - Under unstable or flickering light sources

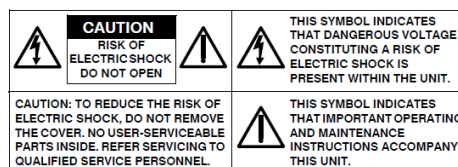
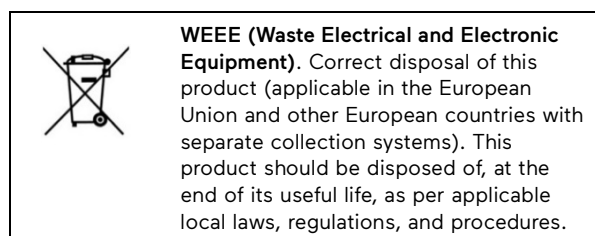

## FC FCC COMPLIANCE STATEMENT

Information to the user: This unit has been tested and found to comply with the limits for a Class A digital device pursuant to Part 15 of the FCC Rules. Operation is subject to the following two conditions: (1) this device may not cause harmful interference, and (2) this device must accept any interference received, including interference that may cause undesired operation. These limits are designed to provide reasonable protection against harmful interference in a residential installation. This unit generates, uses, and can radiate radio frequency energy and, if not installed and used in accordance with the manual, may cause harmful interference to radio communications. However, there is no guarantee that interference will not occur in a particular installation.

**If this unit does cause harmful interference to radio or television reception, which can be determined by turning the unit off and on, the user is encouraged to try to correct the interference by one or more of the following measures:**

- Reorient or relocate the receiving antenna.
- Increase the separation between the unit and receiver.
- Connect the unit to an outlet on a circuit different from that to which the receiver is connected.
- Consult the dealer or an experienced radio/TV technician for help.

**CAUTION** Changes or modifications not expressly approved by the party responsible for compliance could void the user's authority to operate the unit.

## CE CE STATEMENT

Operation is subject to the following two conditions: (1) this device may not cause harmful interference, and (2) this device must accept any interference received, including interference that may cause undesired operation. The manufacturer declares that the unit supplied with this guide is compliant with the essential protection requirements of EMC directive and General Product Safety Directive GPSD conforming to requirements of standards EN55032, EN55035, EN61000-3-2, EN61000-3-3, IEC 61000-4-2, IEC 61000-4-3, IEC 61000-4-4, IEC 61000-4-5, IEC 61000-4-6, IEC 61000-4-8, and IEC 61000-4-11 for emission and immunity and UKCA.

This product is IP67 rated for outdoor environments and IK10 rated for impact protection. The camera also product meets regulations required to be NDAA, GSA schedule and TAA approved.

# IN THIS GUIDE

<b>WALL MOUNT INSTALLATION</b>	<b>3</b>
<hr/>	
<b>PACKAGE CONTENTS</b>	<b>3</b>
<b>INSTALLATION</b>	<b>3</b>
Install the Base from Fixture Kit	3
<b>Mount the Base to the Surface</b>	<b>5</b>
Connect the Cables	8
Assemble the Components	9
Install the Camera Sensor	11
Installing the Wall Mount with the Conduit Box	13

# WALL MOUNT INSTALLATION

## PACKAGE CONTENTS

### Wall Mount VNX-AC-WBBK-0

- Wall Bracket

When unpacking, check to see if there is any visible damage to the appearance of the mount. Remove any protective materials from the bracket after every item is properly checked.

## INSTALLATION

Select a mounting location that is clear from any obstacles, such as steel beams, pipes, etc., that would interfere with mounting. Route any necessary cabling to the installation site.

### Install the Base from the Fixture Kit

The centerline refers to the home position of the camera lens, and before you begin your installation, you'll need to determine where that home position will be. Once installed, the "C" (for centerline) on the Base will align with the Vicor logo on the Solo Fixture and the lens home position (default position out-of-the-box). So, before you mount the Base to its surface, make sure the "C" on the Base reflects your home position.

For **wall surface mount applications**, the centerline will be facing down.

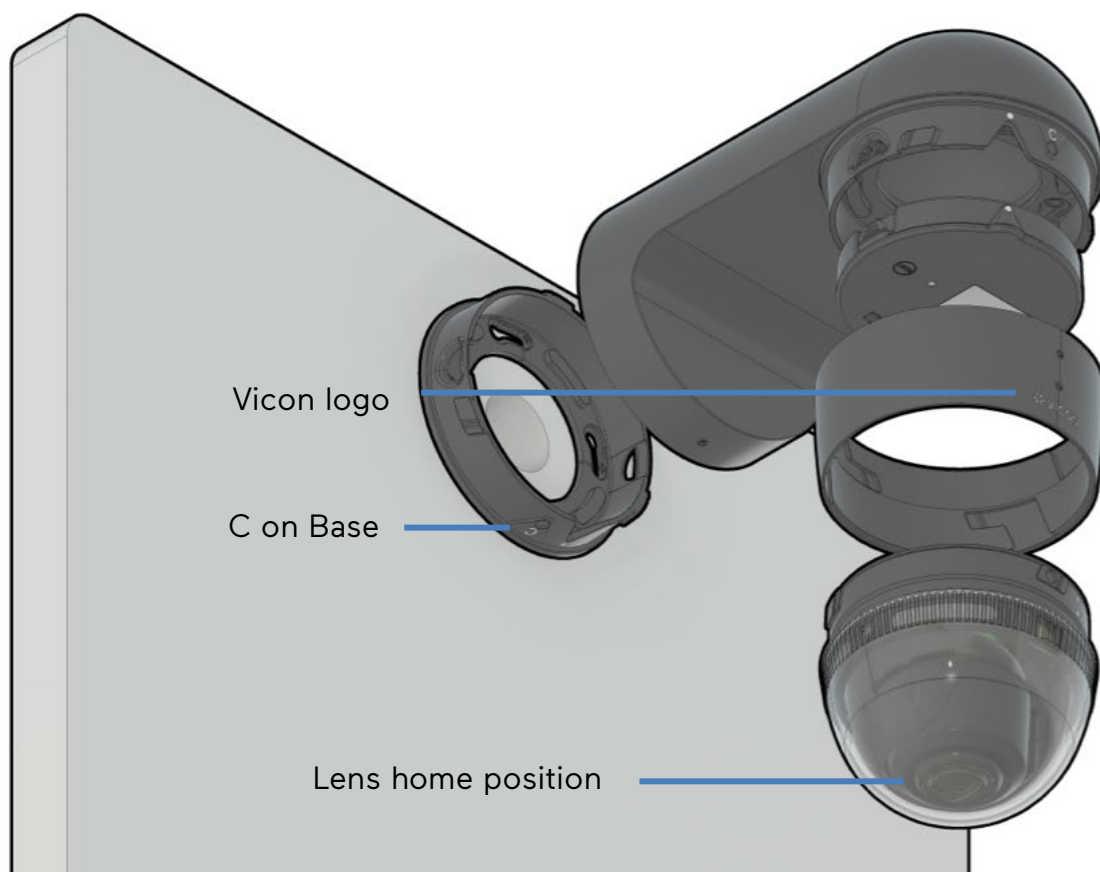

## Mount the Base to the Surface

1. Drill a cable access hole in the surface where the camera will be mounted and expose the Ethernet cable and alarm wiring.

**NOTE:** Provide sufficient cable length to run through the Wall Mount.

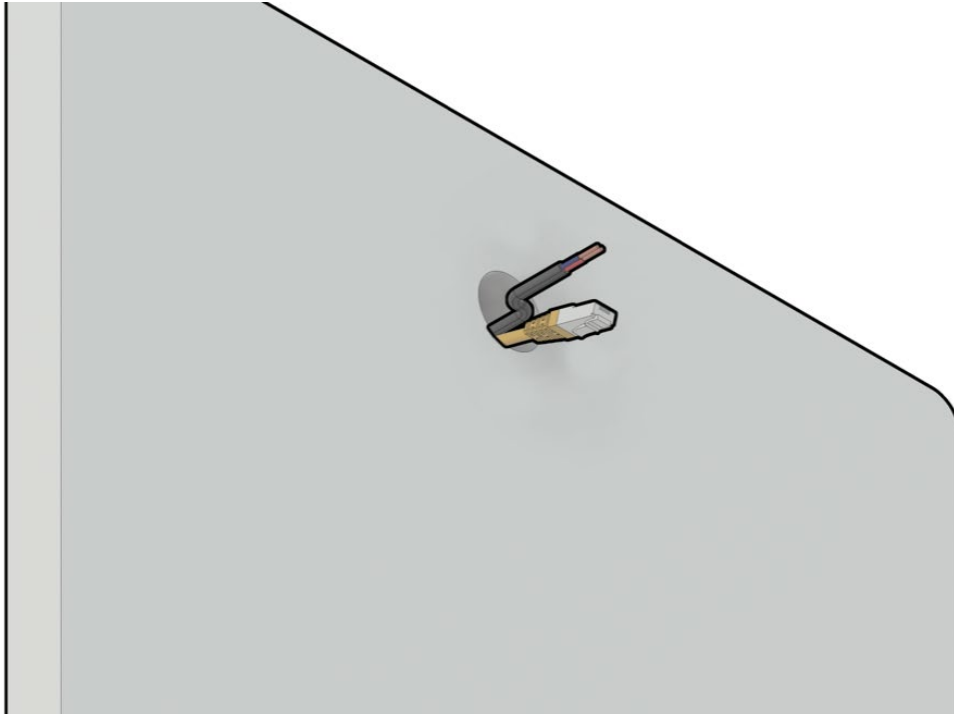

2. Once you've determined your centerline, use the Base to mark holes for the four mounting screws.

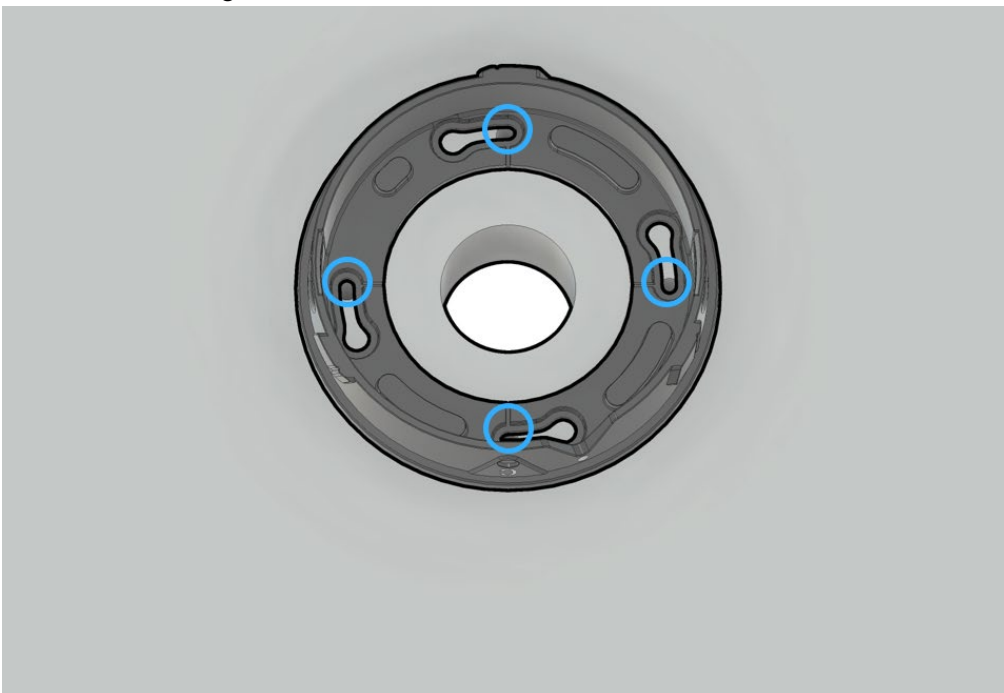

Reminder: The "C" on the Base indicates the centerline, which is the lens home position. For wall mount applications, the C should be facing the floor.

3. Set the Base aside; drill holes and install plastic anchors in those holes (Ø6.35 mm).

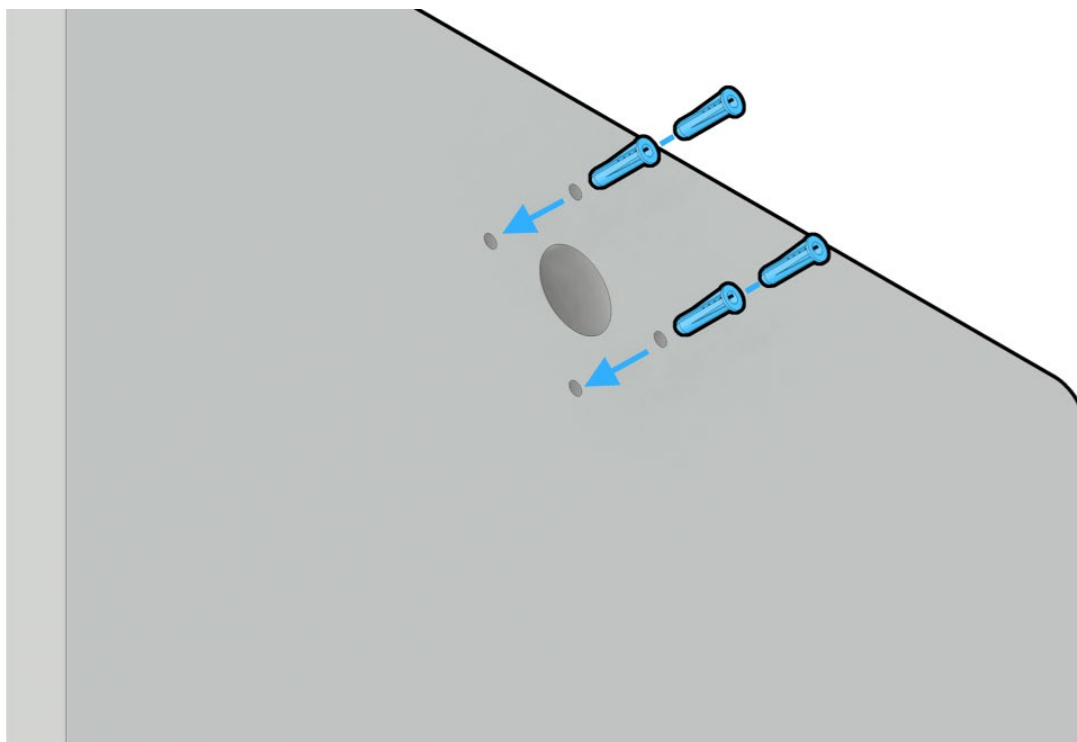

4. Reposition the Base and attach it to the surface using supplied screws.

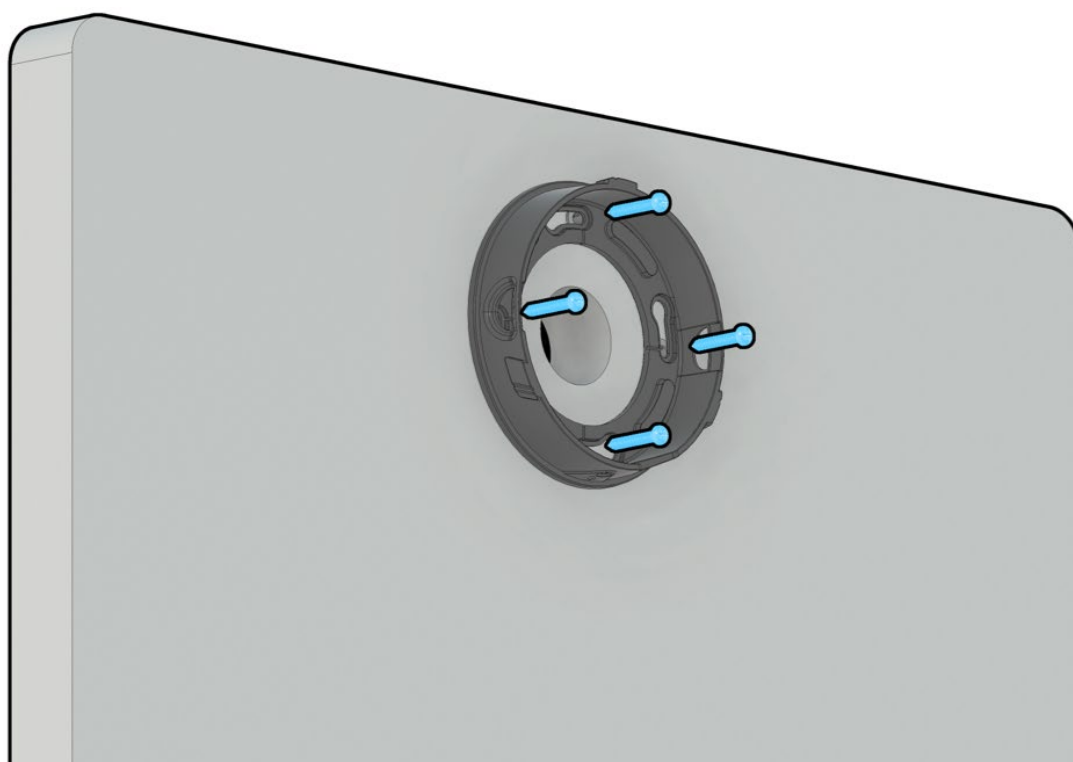

5. Run Ethernet and Alarm I/O cable through the Base.
6. Run Ethernet and Alarm I/O cable through the Wall Mount.
7. Twist install the Wall Mount to the Base.

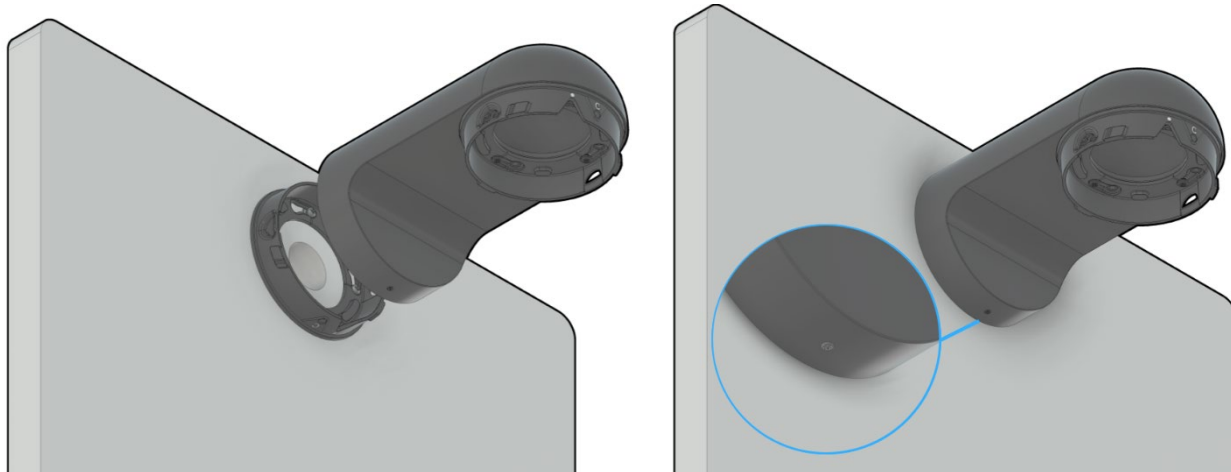



## Connect the Cables

1. Connect Ethernet and Alarm I/O cables as required to the pigtail of the Network Hub (use RJ-45 connector kit as required for outdoor installations).

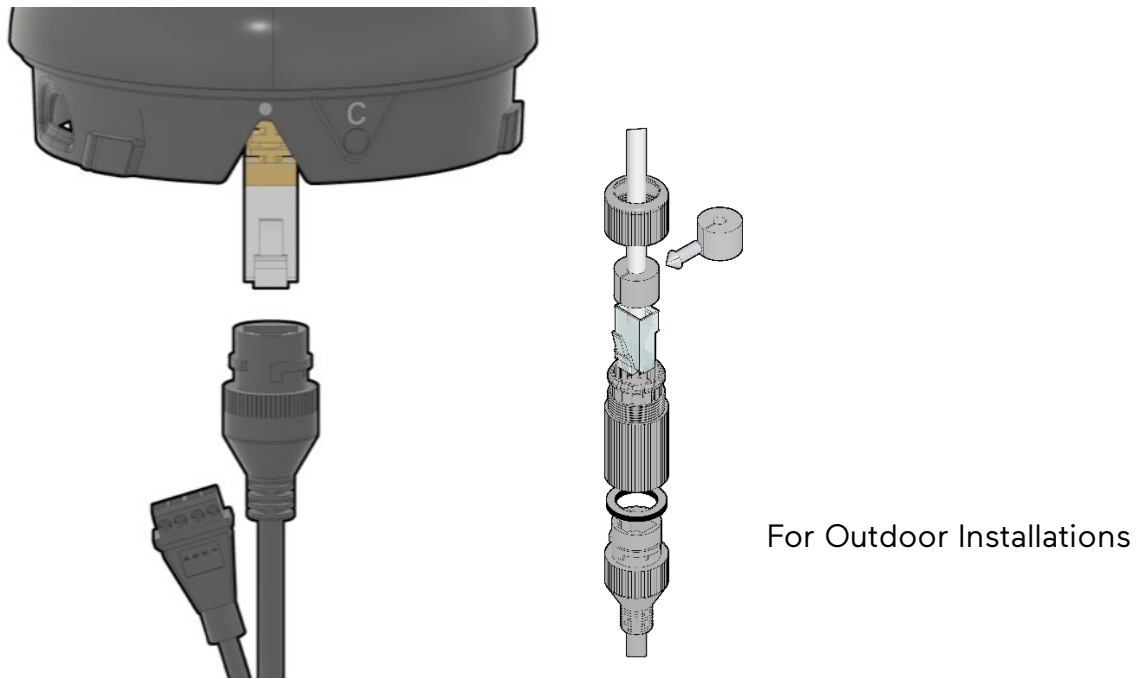

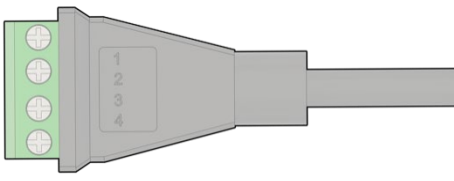
<p>PIN 1 = ALARM IN -</p> <p>PIN 2 = ALARM IN +</p> <p>PIN 3 = ALARM OUT -</p> <p>PIN 4 = ALARM OUT +</p>	
---	--

2. Push cables back into the Wall Mount.

## Assemble the Components

1. Align the single dot indicator on the Network Hub with the dot on the Wall Mount and firmly snap the Network Hub into place.

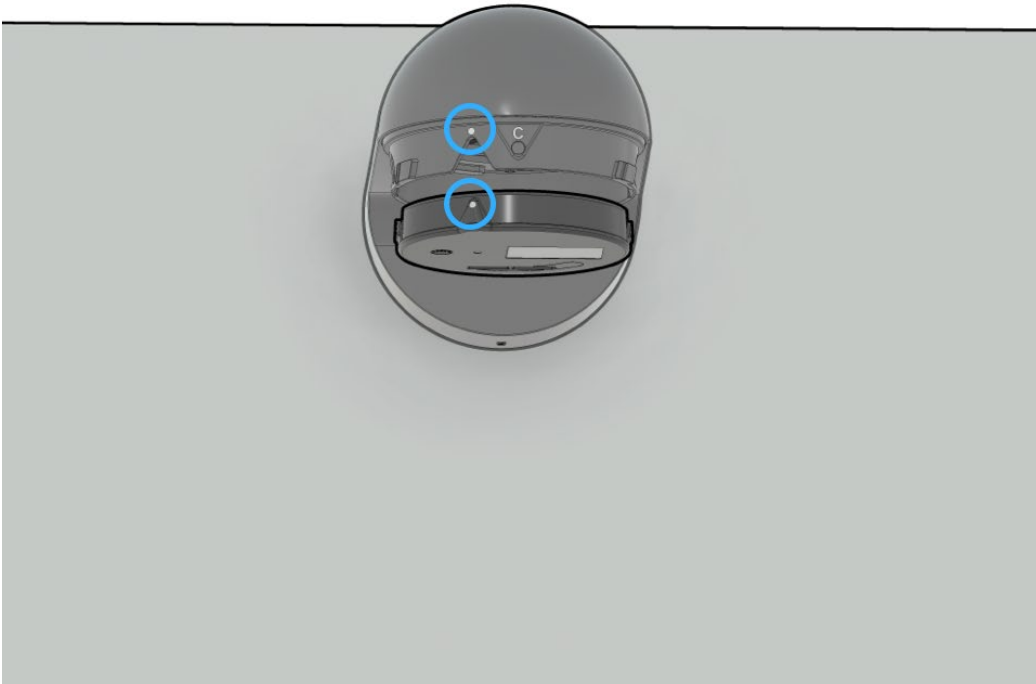

2. Align the two lock screws on the Solo Fixture with the double dot indicators on the installed Network Hub.

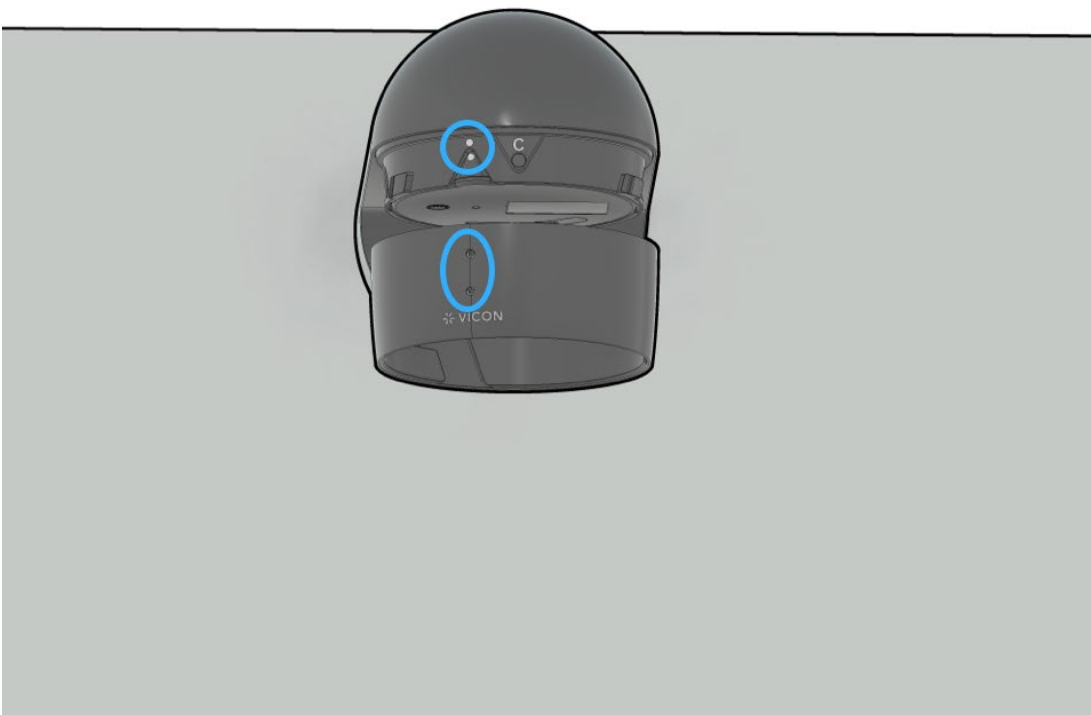

3. Twist the Solo Fixture to the right to lock it into place. The Vicon logo on the Solo Fixture is now aligned with the Base's centerline ("C").

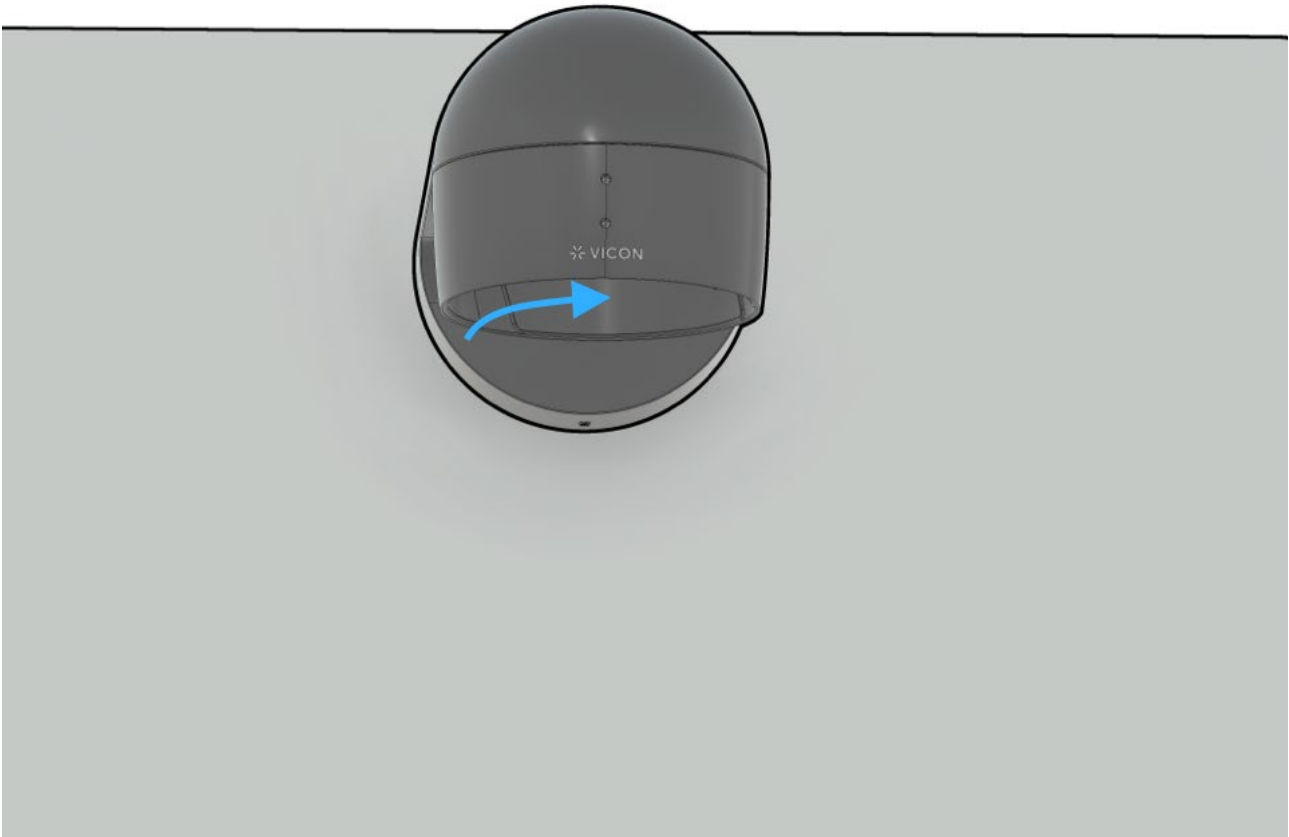

## Install the Camera Sensor

1. If using edge recording for On-Prem or Anavio solutions, install the Vicon Edge Recording Card (VNX-EL-SD1T-0).

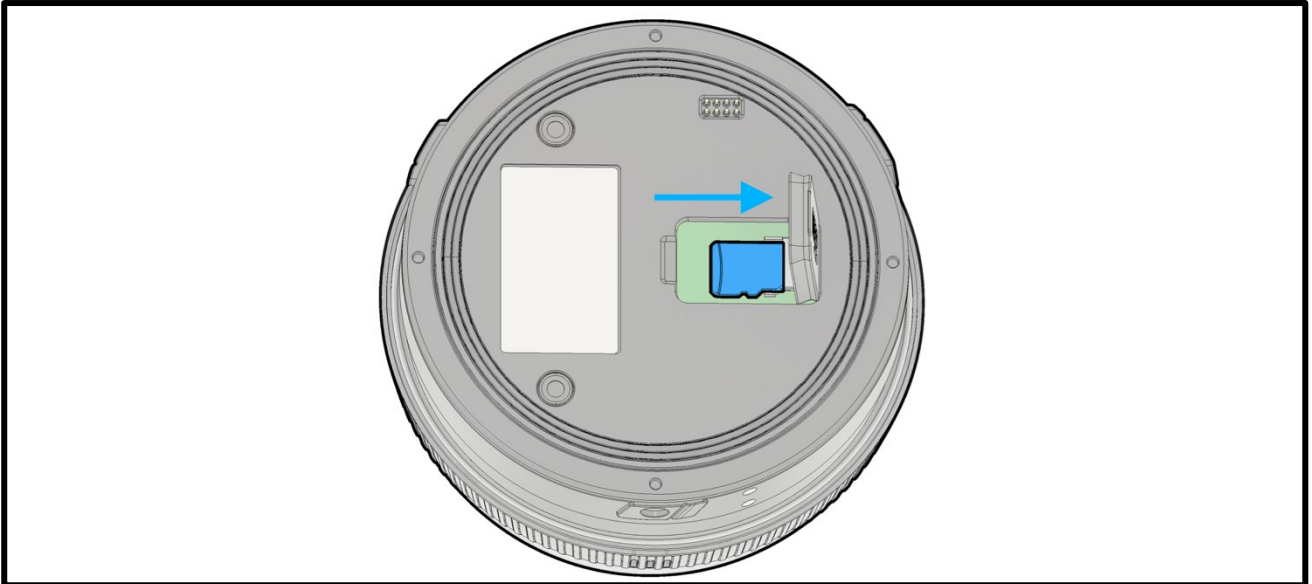

**NOTE:** Only the Vicon Edge Recording Card VNX-EL-SD1T-0 is accepted.

2. Align the double dot indicators on the Camera Sensor with the two lock screws on the Solo Fixture, then twist it to the right to lock it into place.

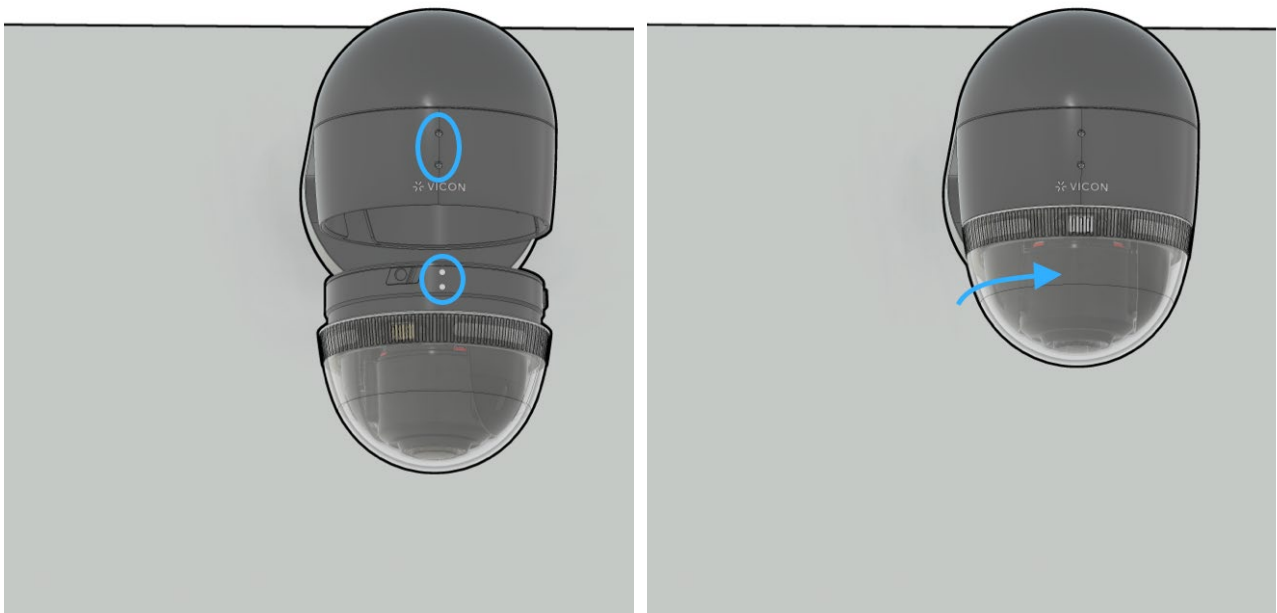

3. Upon successful power-up, the LED lightbars on the Camera Sensor will flash green for 5 seconds.
4. Turn the security screw approximately 2 turns maximum until it contacts the Base and Camera Sensor. This prevents the camera from being removed. No torque is required. For added security, use the T8 Security Torx wrench to tighten the three lock screws (2x on Fixture, 1x on Wall Mount).

**NOTE:** Do not overtighten; overtightening can strip the threads.

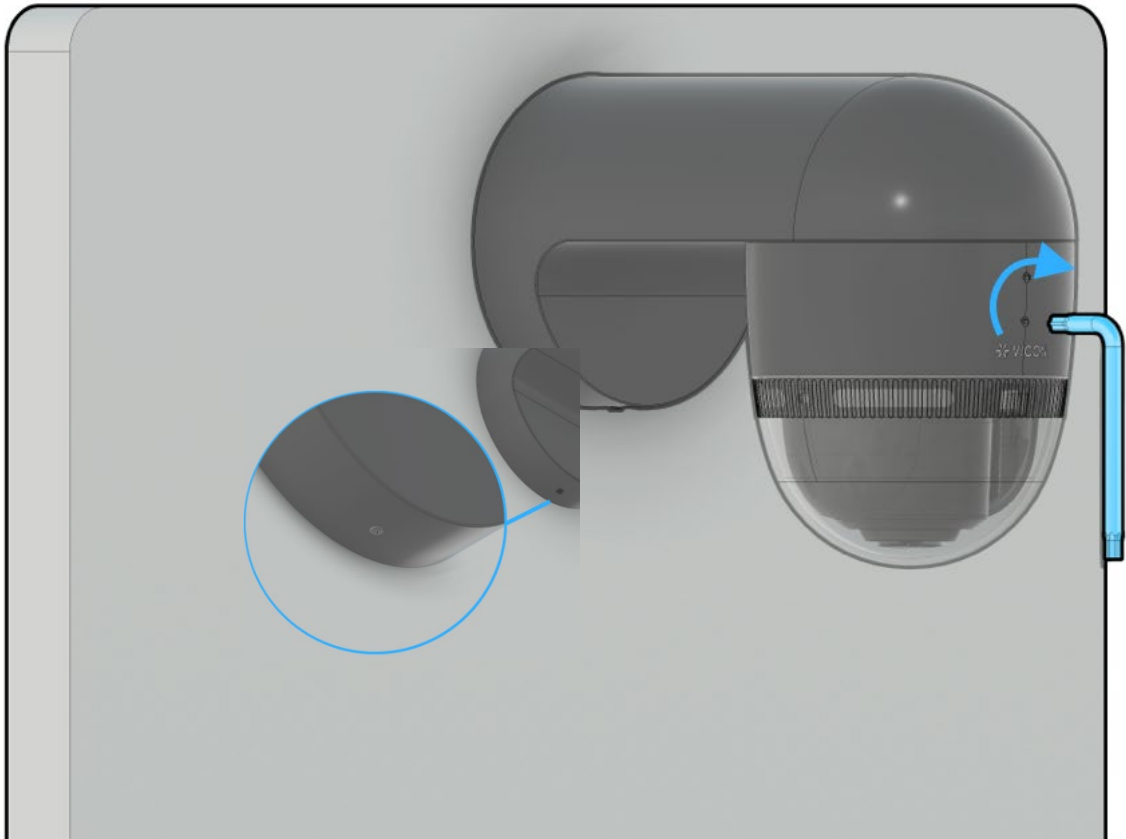

## Installing the Wall Mount with the Conduit Box

1. Identify the Centerline and Security Lock Screw on the Conduit Box cover.
2. Open the hinged cover of the Conduit Box.



3. Remove the conduit plug from the cable access hole that will be used for conduit entry for this installation (there are 4x conduit plugs).

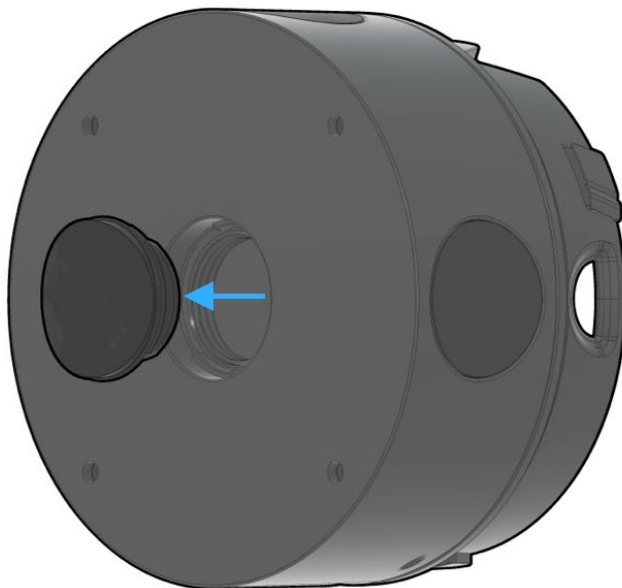

4. Using the Conduit Box as a template, mark the mounting holes.

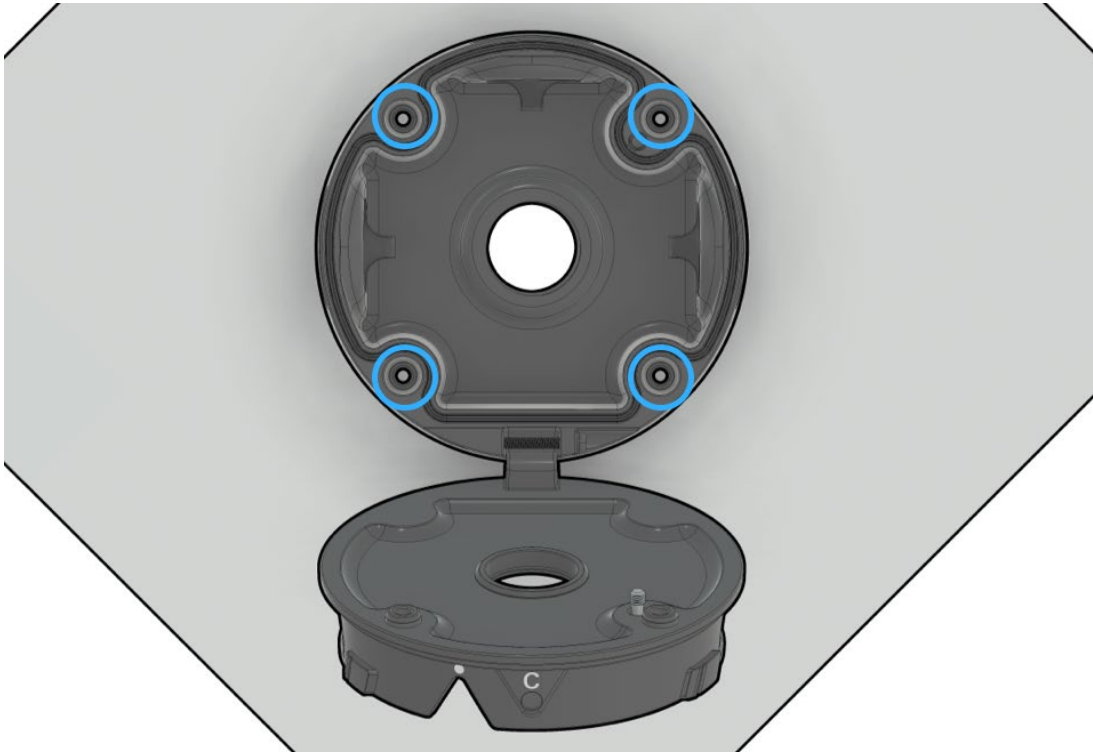

**NOTE:** The C indicates the centerline for the camera installation.

5. Drill the mounting holes.
6. Mount the Conduit Box using the TP4 screws with inserts provided or other customer-supplied hardware appropriate for the mounting surface.

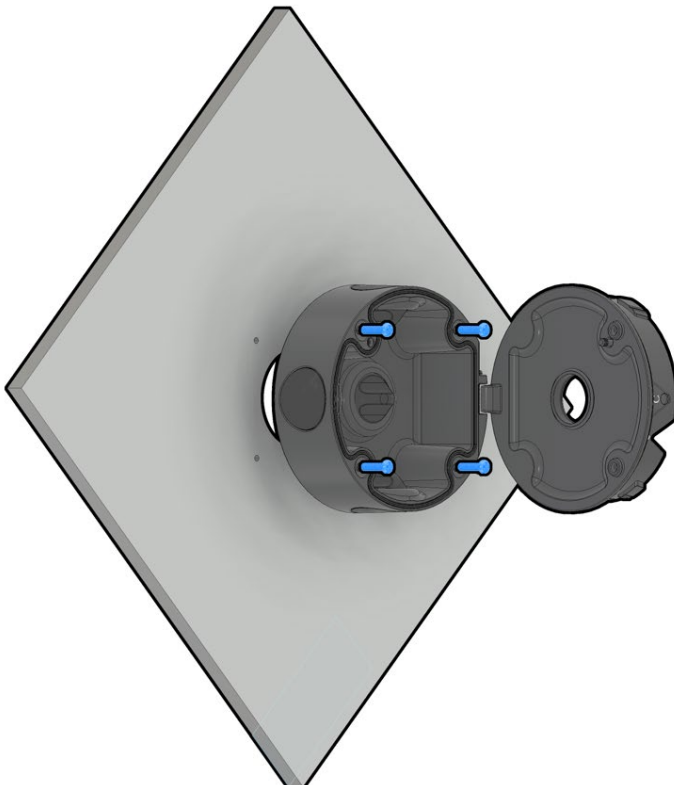

7. Pull cables into Conduit Box.

**NOTE:** Provide sufficient cable length to run through the wall bracket.

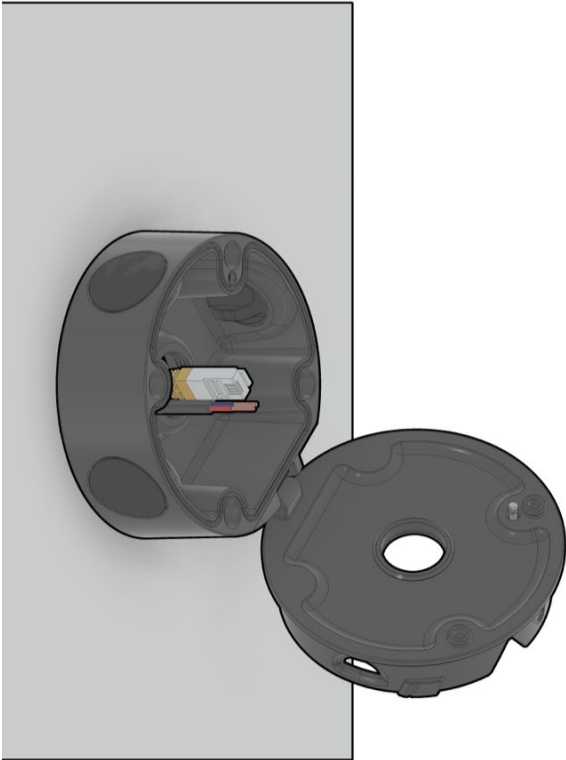

8. Close the cover.





9. Pull cables through the Wall Mount.
10. Twist install the Wall Mount to the Conduit Box cover.

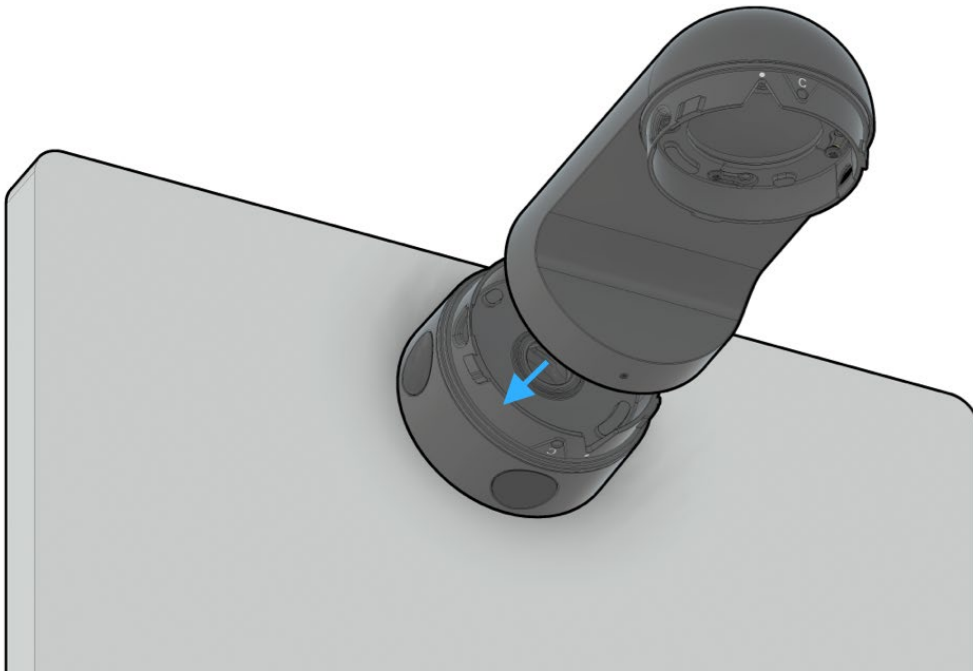

11. Connect Ethernet and Alarm I/O cables as required to the pigtail of the Network Hub.
12. Push cables back into the Wall Mount.
13. Align the single dot indicator on the Network Hub with the dot on the Wall Mount and snap the Network Hub into place.

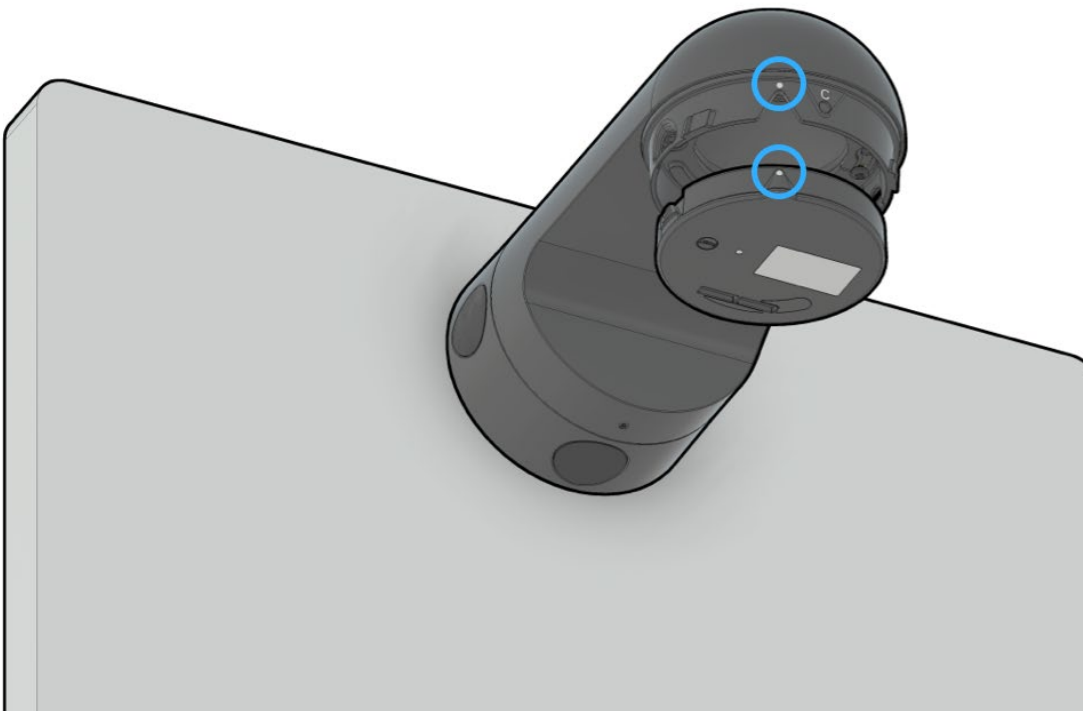

14. Align the two lock screws on the Solo Fixture with the double dot indicators on the installed Network Hub.

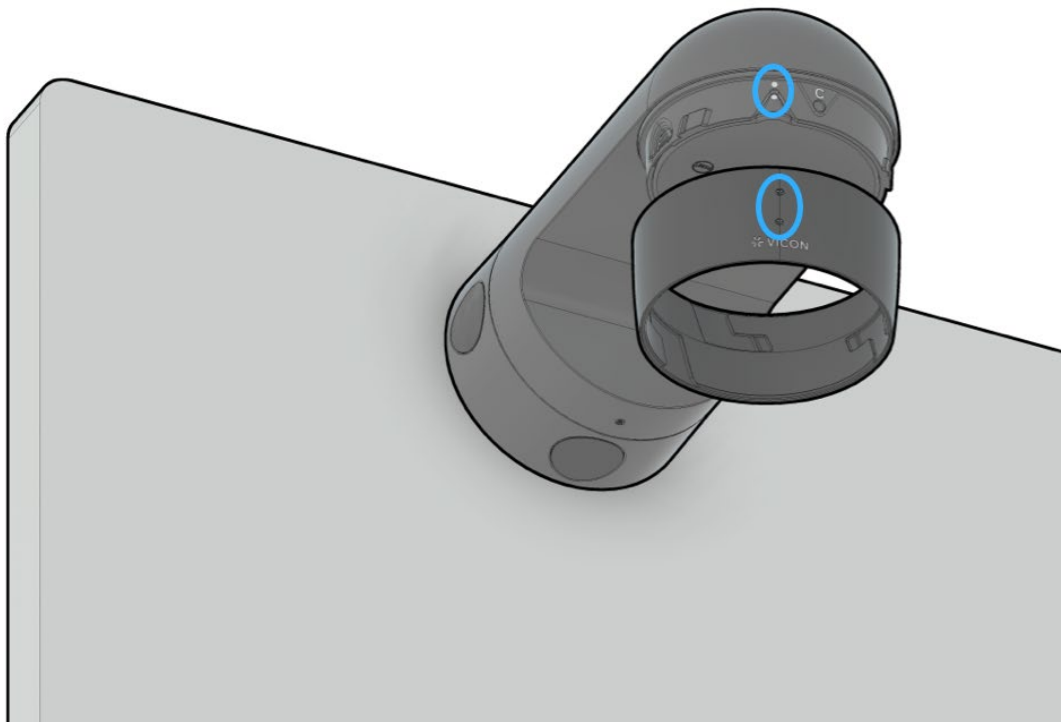

15. Twist the Solo Fixture to the right to lock it into place. The Vicon logo on the Solo Fixture is now aligned with the Base's centerline ("C").

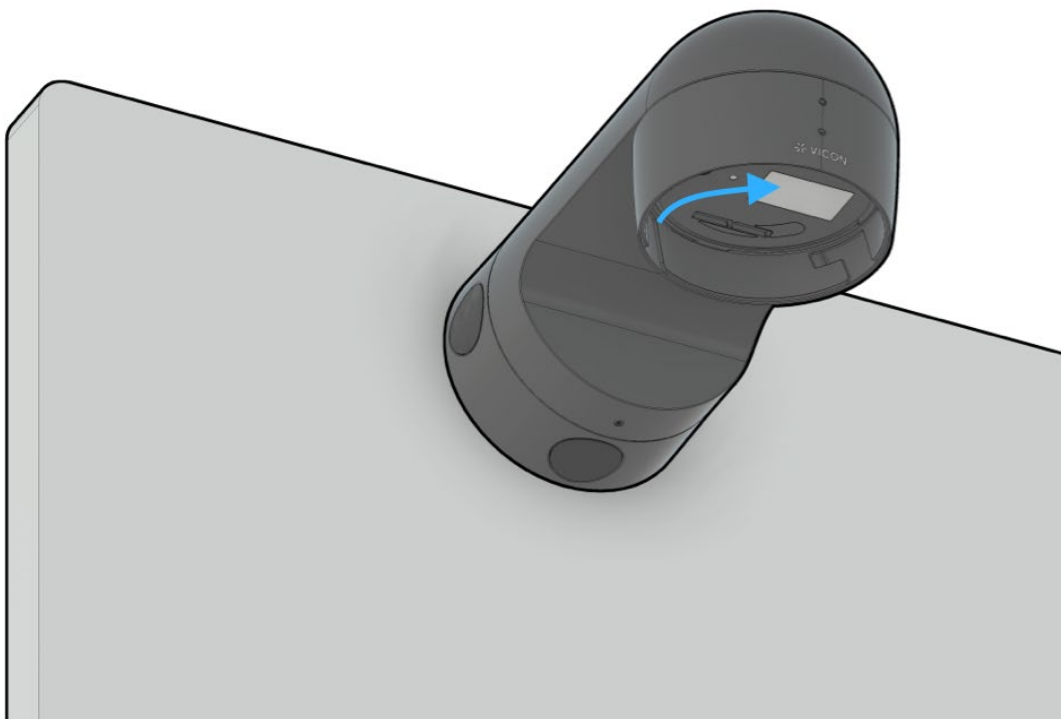

16. If using edge recording for On-Prem or Anavio solutions, install the Vicon Edge Recording Card (VNX-EL-SD1T-0).

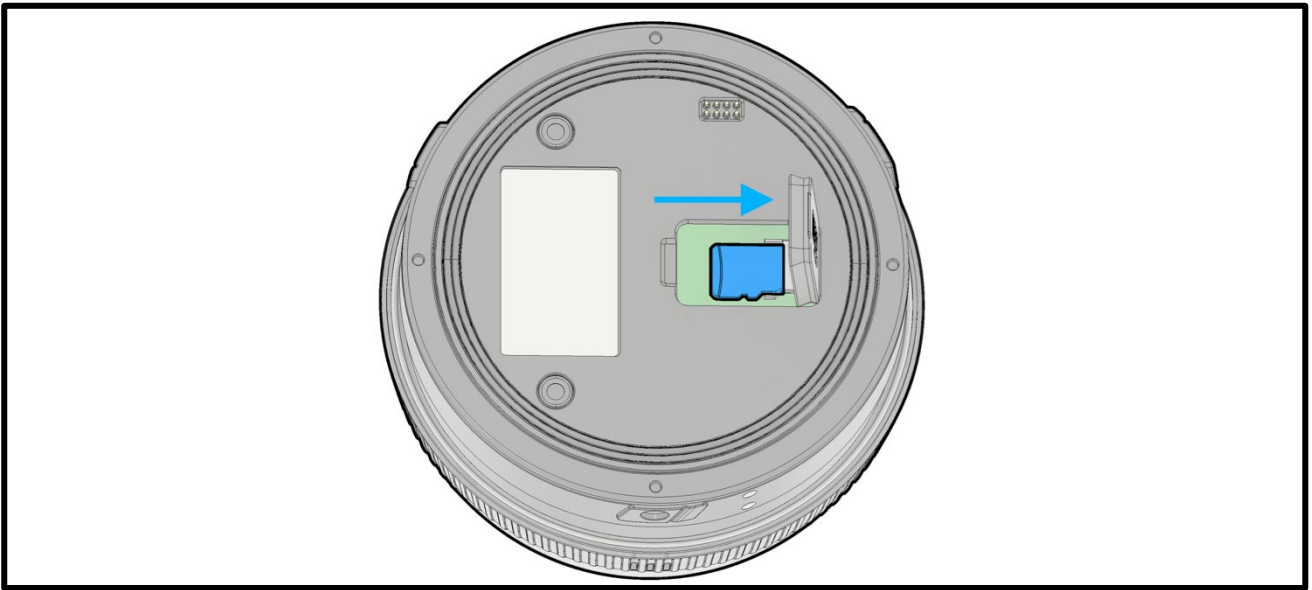

**NOTE:** Only the Vicon Edge Recording Card VNX-EL-SD1T-0 is accepted.

17. Align the double dot indicators on the Camera Sensor with the two lock screws on the Solo Fixture, then twist it to the right to lock it into place.

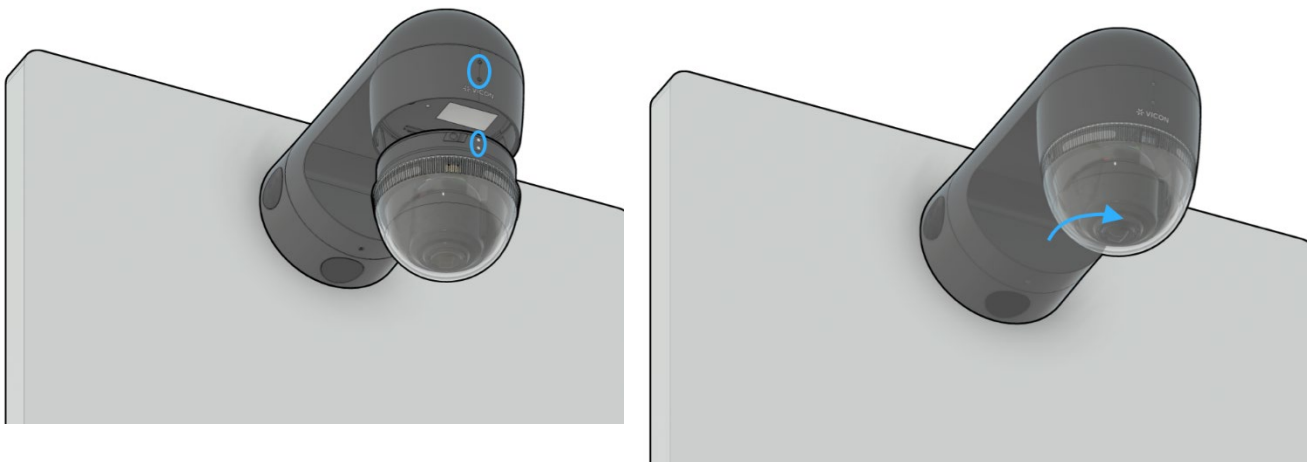

18. Upon successful power-up, the LED lightbars on the Camera Sensor will flash green for 5 seconds.
19. Turn the security screw approximately 2 turns maximum until it contacts the Base and Camera Sensor. This prevents the camera from being removed. No torque is required. For added security, use the T8 Security Torx wrench to tighten the three lock screws (2x on Fixture, 1x on Wall Mount).

**NOTE:** Do not overtighten; overtightening can strip the threads.



Vicon Industries Inc. does not warrant that the functions contained in this equipment will meet your requirements or that the operation will be entirely error free or perform precisely as described in the documentation. This system has not been designed to be used in life-critical situations and must not be used for this purpose.

Document Number: 8009-8344-40-00 Rev: 1/25  
Product specifications subject to change without notice  
Copyright © 2025 Vicon Industries Inc. All rights reserved.

24-Hour Technical Support:  
800-34-VICON (800-348-4266)  
UK: 44/(0) 1489-566300  
Toll Free: 800-645-9116

T: 631-952-2288  
F: 631-951-2288

[vicon-security.com](http://vicon-security.com)